

MULTIPANEL[®]

FLOORS

STICK RANGE

Recommended Tools

- Utility knife
- Straight edge
- Hand roller
- Tape measure
- Pencil



INSTALLATION GUIDE

Pre-installation

Prior to installation, Multipanel recommend that you visit our **video** section on www.multipanel.co.uk, where you will find a complete Stick flooring animation.

Pre-installation check-list

Checked?

Inspect flooring for any flaws, defects or damage	Y / N
Check colour and pattern concentration consistency between all pieces.	Y / N
If flooring is being fitted by a tradesman, colours should be approved by end user.	Y / N
Condition flooring at room temperature for 48 hours.	Y / N

MATERIAL NEEDED FOR INSTALLATION

Most installations require 10% overage for cutting (waste) and mistakes but that can vary depending upon the room size and layout. For installations on a diagonal allow a 25% overage when purchasing Stick. It is always recommended to have extra planks available after the installation is completed for future needs or replacement. Make sure the correct number of cartons and pattern/colour name are on the job site and also make sure all of the cartons are from the same run number (dye lot). The run number is located on the ends of the cartons. Some slight colour variation can happen from run to run. It is preferable to install planks/tiles from more than one box at a time (min. 3-4 cartons) to create good random effect, in smaller areas where less packs are required this may not be possible.

HOW MANY CARTONS TO PURCHASE

Example: 10' x 10' room installation (100 sq.ft.) including 10% overage = 110 sq.ft.

Product Name	Plank Size	Sq.Ft / Carton	M ² /Carton	# of Cartons
Stick Plank	6" x 36" (914 x 152mm)	24 23.2	2.2 m ²	5 (120 sq.ft.) / (11 m ²)
Stick Tile	12" x 36" (914 x 304mm)	24 23.2	2.2 m ²	5 (120 sq.ft.) / (11 m ²)



CONDITION STICK PRIOR TO INSTALLATION

Stick flooring Plank and Tile must be acclimated in the room of installation for a minimum of 48 hours with the temperature between 18°C & 30°C before, during and after installation. The HVAC system should be operational at least two weeks prior to installation and remain on after installation as Stick flooring must be in a temperature controlled environment. Product should be stored horizontally in a dry area away from direct sunlight. Do not leave next to heat or cooling ducts. Leave the planks inside the cartons to ensure the GripStrip™ remains clean. Keep dust, dirt and foreign particles from contaminating the GripStrip™. Ensure that all trades have been completed to eliminate dry wall dust, paints etc.

Following these steps is CRITICAL for adhesive performance during installation! Failure to follow these guidelines will void the warranty.

INSTALLATION LIMITATIONS

Stick flooring is for interior installations and only in temperature controlled environments. DO NOT INSTALL Stick over carpets, or any foam underlayment. This product is not suitable for any outside use, sunrooms/solariums, saunas, seasonal porches, camping trailers, boats, Recreational Vehicles (RVs), or any room with the potential of flooding. Avoid long term exposure to direct sunlight. Failure to properly shade Stick flooring from the effects of the sun can result in GripStrip failure, discolouration, fading, or buckling of the floor. Use window treatments such as blinds, curtains, diffuser films or UV tinting on windows to reduce any direct sunlight for prolonged periods. Stick is not intended for use on stairs or any vertical surface. Do not glue, nail, screw or fasten to substrate. Install cabinetry, island and peninsula counters, vanities, tubs, and showers first. Then, install Stick flooring around them.

Failure to follow these guide lines will void the warranty.

IMPORTANT NOTE: Carefully inspect each plank for visual defects prior to installation. Do not install damaged planks. After installation, the room temperature should not be allowed to go below 55°F (13°C) or above 85°F (30°C) and rapid fluctuations in room temperature should be avoided.

SUBFLOOR PREPARATION

The subfloor surface must be smooth, flat, dry, clean and solid. Carpet staples or adhesive residue must be removed to ensure proper installation. Subfloors should be flat within a tolerance of 1/4" (6mm) over 10' (3.05m). Subfloors should not slope more than 1" (2.5 cm) per 6' (1.8 m) in any direction. Rises or voids must be sanded or filled with a cementitious levelling/patching compound.

APPROVED SUBFLOORS

Concrete

Any large cracks or voids must be filled with a cementitious patching/levelling compound. (over 1/8" x 1/8") (3mm x 3mm)

PLEASE NOTE: Stick flooring is water resistant and will withstand holding water for short periods of time if the product is installed properly. Stick flooring is not flood proof! Stick flooring is not meant as water proofing material nor a solution for moisture. Moisture intrusion is a totally different situation that can arise with new and old concrete that exhibits very high levels of hydrostatic pressure in combination with very high levels of alkalinity. This combination provides a substance that is highly corrosive. No floor covering including Stick flooring can withstand the long term corrosive nature of this chemical. If hydrostatic pressure exceeds 8 lbs (using the calcium chloride test method) and/or a P.H test indicates alkalinity levels in excess of 9, then steps must be taken to separate Multipanel Stick flooring from the source of the corrosive effect of this chemical. Excessive moisture in the subfloor can cause mould and mildew and other moisture related issues including, but not limited to, trapping of the moisture emissions under Stick. Under these circumstances the concrete needs to be treated with a floor sealer that seals the concrete under the 8 lbs or a moisture/ vapour barrier (6 mil poly) is installed. This is necessary to avoid the corrosive effects. Newly poured concrete floors must cure for a minimum of 90 days. It is the responsibility of the home owner and the installer to make sure that any moisture or alkalinity issues are resolved prior to installing Stick flooring.



Wood subfloors

Hardwoods, Plywood, OSB, Luan & Particleboard are approved, but must be sturdy, flat and have little flexibility.

IMPORTANT NOTE: Never install over wooden subfloors which are installed over concrete.

Quarry tile, terrazzo and ceramic tile

Stick flooring can be installed over these floors, but fill grout lines with a cementitious leveling/patching compound.

Radiant heated floors

Electric and Hydro heating systems are acceptable. However NO ELECTRIC MATS ARE APPROVED. Radiant heating system must be cast 1/2" below the surface of the concrete subfloor. The heating system should be operational for at least two weeks prior to installation to calibrate temperature settings. The temperature should never exceed 30°C during and after installation. Existing Resilient floors: Tiles, planks, or sheet goods must be in good condition and thoroughly bonded to the structural floor. Existing floors must not be foam- or cushionbacked vinyl flooring. Deep embossing (1/8") must be skim-coated with floor leveler. Installation over one layer of existing vinyl is approved. Note: Do not sand, saw, pulverize, chip, bead blast, or dry scrape existing vinyl floor, backing, lining felt, asphalt, "cut back" adhesives or other adhesives as they may contain asbestos fibers and or crystalline silica. Various Local government agencies have regulations for removal of in-place asbestos-containing materials. If you are considering removing an existing floor covering that contains (or is presumed to contain) asbestos, you must review and comply with all applicable regulations.

Suspended wood floors (mobile homes)

Must have a minimum of 18" well ventilated crawl space underneath the floor joists. A moisture barrier must be installed over the ground. Do not install when the floor is exposed to the elements.

PRODUCT INSTALLATION SPECIFICATIONS

Connection type	Adhesive GripStrip
Free floating floor	Yes. DO NOT screw or nail moldings, transitions, cabinetry or vents through ANY Stick flooring
Acclimation period	48 hours minimum required in room prior to installation
Temperature range during acclimation & install	18°C to 30°C required in room of installation. After installation temperature should stay between 18°C to 30°C
Interior product only	Yes. See limitations/exclusions below
Storage	Horizontally
Dye lots	Yes. It is preferable to install from a minimum of 3 to 4 different boxes and dye lots at one time. See page 3 of Owner's Manual for more information
Expansion space	Yes. For room perimeters and fixed objects please leave 1/4" (6 mm) optimum space
Floor flatness tolerances	1/4" (6 mm) over 10' (3.05 m). Use floor leveler when exceeding tolerance
Hand roller required	Yes
75 lb min. floor roller	Yes



MULTIPANEL®

Don't tile it. Multipanel it.

Moisture reading guidelines; OVER CONCRETE • 0% to 6% • Over 6%	Based on tramex concrete moisture encounter plus meter (scale 0% to 6%) Use a 6mil poly moisture barrier DriCore recommended
Moisture reading guidelines; OVER WOOD Scale 0 to 13%	Never use 6 mil poly over wooden subfloors OK to install. Do not install above 13% moisture levels
Primer over wooden subfloors	No
Basement proofer over concrete	No
Moisture barrier (6 mil poly)	YES over concrete only.
Installs over radiant flooring	Yes. Electric or hydronic approved — best practice recessed min 1/2" (12.7 mm) below finished floor. Do not turn thermostat above 30°C
Suspended wood floors	Yes. 18" (45.72cm) minimum well ventilated crawl space Use moisture barrier over ground/dirt Especially for mobile home installations
Foam/cushioned underlayment	No. Voids warranty if used in any application
Approved subfloors - see below	Must be smooth, solid, dry and no deflection
Wood subfloors	Yes. Solid, engineered, parquet (not over concrete)
Sheet subfloors	Yes. OSB, plywood & particleboard are approved for Stick products only. Luan is approved for all products
Vinyl	Yes, install over 1 layer of vinyl only. Linoleum, VCT, LVT, peel & stick
Concrete	Yes. Sealed, unsealed, poured in place gypsum On grade or below grade (see moisture guidelines)
Tile (stone)	Yes. Ceramic, terrazzo, stone tile (grout lines of less than 1/4" (6 mm) is optimum)
Dricore	Yes
Subfloors not approved	Carpet (any type), foam underlayment, cushioned back vinyl, rubber, cork, laminates, free-floating
Subfloor approved products	Basement proofer - custom building products RedGard or TM Basement Proofer, floor leveler - Henry 554 & 555 Level Pro
Limitations/exclusions	These types of installations will NOT be covered under warranty: All exterior installations & seasonal porches, boats/campers/RV's, sunrooms/solariums, non-temperature controlled rooms or homes
Steam cleaner	DO NOT USE
Vertical surfaces & staircases	Not covered under warranty. Can be done using high quality construction adhesive. Product not intended for this usage
Limited warranties	See page 8



PROPER INSTALLATION TECHNIQUES

When installing Stick flooring it is vital for successful installation that pressure is exerted when attaching plank to plank. Utilize a hand roller directly on the joined seam to create the proper bond between the GripStrips™ as you attach each plank. After completion roll the entire floor in both directions with a 75 to 100 lb roller. Pressure is the key. To ensure proper bonding of the material on the job site, take two planks and attach together and roll with the hand roller and then pull apart. A bond should be observed throughout the whole GripStrip™. Adhesive legs or adhesive transfer should be seen on the GripStrips™. This will confirm the material has been acclimatised properly and the temperature of the Stick is ready for installation.

INSTALLATION

Plan your layout before installation starts. Measure the length of the room and divide by the length (long side) of the Stick flooring plank you are installing. If the number is less than 12" you need to cut your first plank accordingly to avoid planks less than 12" on the opposite side of the room.

Also measure the width of the room. Divide the width of the room by the width of the Stick flooring plank (short side). If the number is less than half the width of the plank, then your first row needs to be cut length wise on both the first and last rows (they should be the same width on the first and last rows). Avoid having a row of less than half the width of the plank being installed. To cut a plank simply measure and mark the plank, then using your straight edge and utility knife, simply score the plank and snap.

Installation should start in a corner and proceed from the wall with the under-edge facing out away from the wall (Figure 1). Allow a gap of 1/4" (6mm) minimum for subfloor movement, which should be covered by molding or skirting/plinth. Trim off the top over-edge facing the wall (the entire length of the first row as well as the over-edge on the short side of the first plank) (Figure 2).

When securing two planks together, you should angle the second plank by 45 degrees into the corresponding edge of the first plank. The over-edge is always placed on top of the underedge. Starting at one end of the plank, use one hand to hold the plank and the other hand to roll the edge into place for a tight fit. Be careful to keep the seams tight. You can push the plank slightly against the adjoining plank to create a tight seam, if necessary after the connection has been made.

If your seam does not appear to be tight, you can immediately pull apart the planks and reapply it. Slowly separate the top plank away from the bottom plank and simply reapply them. Be careful not to pull the planks apart too fast as you could rip or damage the GripStrip™. You have a couple of minutes of "open time" in which you can re-work the seams before any damage occurs to the adhesive on the GripStrip™. The less pressure applied to Stick flooring, the longer this "open time".

When installing the plank, stagger the rows so that the short edge (6") seams are not in a straight uniform line and have a stagger of a minimum of 6" from row to row. We recommend the staggered random method (Figure 3).

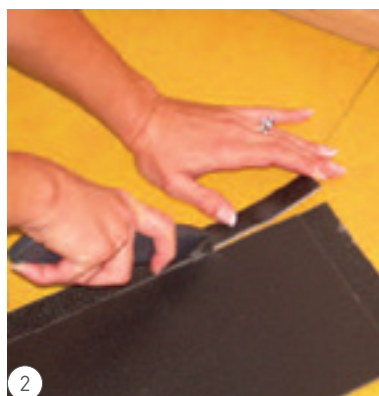



Start the second row with the plank cut at about 2/3 length (2 feet). Measure and mark the plank, then using a straight edge and utility knife, simply score the plank and snap.

The over-edge butts up to the first row. Again, get one corner of the plank started tightly against the other, and on a 45 degree angle, roll the plank tightly into place. The remaining 1/3 piece can be used on the far wall, if the layout of the room permits (Figure 4).

Start the third row with the plank cut at 1/3 of a length (1 foot). Again, the leftover piece can be used at the opposite end of the row, if the layout of the room permits. Continue this pattern for the remainder of the rows to be installed. Always place the cut end of the first plank against the wall (Figure 5).

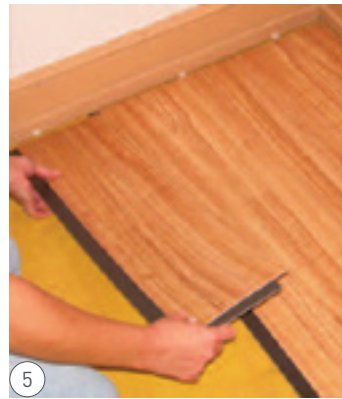

Fitting around irregular objects is no problem. Simply make a pattern out of heavy paper to fit around pipes or irregular objects. Place the pattern upon the plank and trace. Cut along trace lines using a utility knife or heavy duty scissors, snips or coping saw and lay plank. The sheets of paper between the planks inside the carton make an excellent template.

Undercutting door casings: To ensure Stick flooring will fit underneath the door casing and not expose a 1/4" expansion space, place a hand saw on the back of a plank and cut the door casing to the height of a plank.

After installation is completed, we recommend rolling the seams with a 75- 100 lb floor roller in both directions to ensure bonding of both adhesive edges. You can rent a floor roller from your local tool rental center.

IMPORTANT INSTALLATION TIPS

Stick flooring is installed the same way as described on the previous page. However, you can install two ways. One is the traditional lining up of the grout lines or you can install in a brick pattern where the grout lines line up in the middle of each tile.

Note: Stick flooring is randomly packaged and we recommend that you install planks or tiles from 3 to 4 packs at one time to ensure a random effect.

Stick flooring has two sets of grout lines (inner & outer). When installing the tile in a matching grout line pattern, you must pay special attention to the "outer" grout lines at the end of the tile planks. One is thinner than the other. It is recommended you match a thin grout line to a thicker grout line. It helps in maintaining the grout line to grout line look. It takes more time to install the tiles this way and will require installing from several different cartons at one time.

The alternative method to installing the tiles is in the brick pattern. This is faster and easier to install this way and also gives a beautiful design to the floor.

Be sure to ask the customer which way they prefer to have the tiles installed.



MULTIPANEL®

Don't tile it. Multipanel it.

KEY INSTALLATION TIPS

Do not install in	All exterior installations, non temperature controlled homes or rooms (seasonal porches or garages), sunrooms/solariums, boats, campers, RV's
Acclimation	48 hours with room temperature between 18°C - 30°C
Subfloor flatness tolerances	1/4" (6mm) over 10' (3.05m). Substrate should not slope more than 1" (2.5cm) over 6' (1.8m) in any direction.
Radiant heated floors	System must be cast 1/2" (1.3cm) below the surface of substrate. Do not use heating mats.
Expansion space	1/4" (6mm) around perimeter walls, cabinetry, or any fixed objects. Cover gaps with a bead, skirting or plinth.
Free floating flooring	Do not glue, nail, screw or fasten to substrate. Install all cabinetry, island and peninsula counters, vanities, tubs and showers first. Then install floor around them.

CARE & MAINTENANCE

Routine maintenance

- Sweep, dust mop, dry Swiffer® or vacuum (with hard surface attachment) your floor on a daily basis. Never use a vacuum with a beater bar.
- Use any pH-neutral good quality vinyl cleaner or a non-rinsing, biodegradable cleaner that leaves no residue or haze and requires no rinsing after application.
- Remove any standing water, pet urine and other liquids promptly.

Preventive maintenance

- Use NON-RUBBER backed mats at all entrances to avoid discoloration from asphalt driveways or prevent dirt and grit from being tracked onto your floor. Rubber backed mats can discolor your floor.
- Use flat floor protectors (nylon or felt) on all furniture legs. Clean protectors periodically to remove grit that may become embedded and cause scratching.
- Do not drag or slide heavy furniture or objects across your floor to avoid scuffing and scratching.
- Do not use any dust cleaners as this may cause your floor to become slick or damage the finish.
- Do NOT use a steam cleaner of any kind.
- Do not use any abrasive cleaner, vinegar, oil soaps, harsh detergents, "mop & shine" products, bleach or wax (wax will not penetrate Stick and will discolor your floor).
- Avoid spills of paints, dyes, or harsh chemicals.
- Clip pet nails. Pets with unclipped nails may scratch your floor.
- Avoid long term exposure to direct sunlight. Use window treatments or UV tinting on windows.
- For office chairs and rolling furniture, use broad surface non-staining casters at least 2" in diameter.



MULTIPANEL®

Don't tile it. Multipanel it.

WARRANTY

Grant Westfield Ltd offers a reducing 1 year wear warranty that Multipanel® Stick will not wear-out under normal foot traffic. Wear-out means the removal of pattern and colours from the floor. Your Multipanel® Stick warranty covers failure of the GlueStrip and the floor remaining watertight if installed and rolled according to our published recommendations. In the event of a successful claim under your Multipanel® Stick guarantee we will replace the necessary amount of flooring, but will only cover any claims for consequential costs under exceptional circumstances where a defective plank / tile prohibits ordinary use of the surrounding area, e.g. unable to take a shower.

This guarantee does not cover failure of the product due to:

- Faulty installation.
- Wet room or conservatory installation.
- Incorrect maintenance.
- Damage or misuse.
- Damage from underfloor heating > 30°C.
- We do not cover prolonged exposure to direct sunlight.

Prior to installation the following checks should be carried out and any queries reported, as claims of this nature will not be covered:

- Colour matching and sheen levels between different planks of the same finish.

Note. A degree of variation is normal on wood grain planks to ensure an authentic effect.

- If flooring is to be fitted by a tradesman - colours should be approved by the customer.
- If flooring has been stored in cold conditions, it must be left to condition at room temperature for 48 hours prior to installation.
- No dust or foreign particles have been in contact with the gluestrip.
- All products have arrived in good condition.
- Flaws and defects in vinyl - although unlikely.

This guarantee does not confer any rights other than those set out above and claims for consequential loss or damage are excluded.

Grant Westfield Ltd reserve the right to change Multipanel® Stick decor and sizes. We hope that you are fully satisfied with the Multipanel® product you have purchased and that you will return to Multipanel® for all your wall/ceiling lining requirements.

www.multipanel.co.uk

Multipanel®, Westfield Avenue, Edinburgh, EH11 2QH

t +44(0)131 290 2862 f +44(0)131 337 9241 e info@multipanel.co.uk

Multipanel® is part of Grant Westfield Ltd.

